

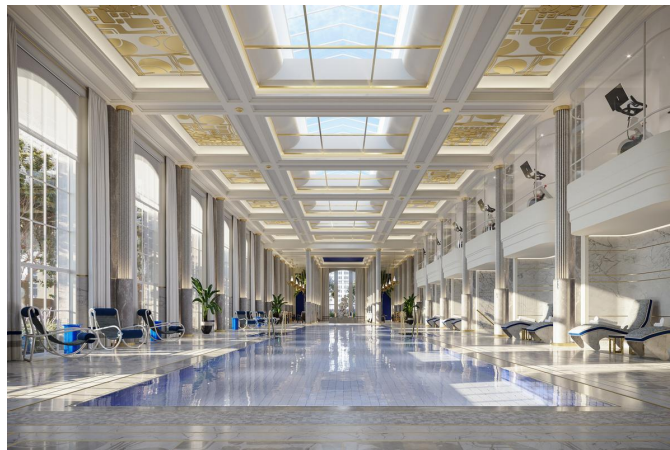

First-ever residences at Waldorf Astoria New York launched for sale

By Stu Roberts
Impressions: N/A



Residences at the Waldorf Astoria New York have been made available to buy for the first time as part of renovation work on the famous Art Deco building that is being led by Skidmore, Owings & Merrill (SOM).

The Waldorf Astoria was originally designed by Schultze and Weaver and was the largest and tallest hotel in the world when it opened on Park Avenue in 1931.

Described as "a beacon of timeless glamour and luxury", it has hosted the world's celebrity elite, world leaders and a wealth of cultural events and galas.

In addition to a 375-key hotel, the newly revamped destination will offer 375 condominium residences to be known as The Towers of the Waldorf Astoria, with homes ranging from studios up to four-bedroom apartments and penthouses, when it reopens in 2022.

The interiors and amenities for the residences have been designed by Jean-Louis Deniot, who has sought to create a modern experience that honours the building's history.

March 5, 2020

CLAD News

"The Waldorf Astoria has a forever lavish aura," said Deniot. "The interiors will reflect the magnificence of the past mixed with today's great sense of energy. They will be grand and playful, all highly inviting, with many elements of surprise and excitement."

Among those elements will be bespoke pieces that he has designed, including interior doors with antique bronze hardware, vanities with polished marble countertops and tile mosaics featuring a Waldorf Astoria-inspired pattern.

Residents will have exclusive access to over 50,000sq ft (4,600sq m) of health and wellness, entertainment and business amenities.

A pool in a double-height space overlooking Park Avenue will be illuminated by a restored skylight, as intended by the original architects.

A fitness centre will feature training studios, a cardio gallery and private spas for men and women with lounges, saunas, steam rooms and treatment rooms.

Spaces for entertainment and entertaining will include bars that reference those of the original hotel, grand function spaces, a private dining room, a wine tasting room, a billiards room and a games room.

There will also be a library and lounge, a theatre with a performance stage and a grand piano, private workspaces, meeting rooms and a co-working space.

Residents will have access to the hotel's 100,000sq ft (9,300sq m) of amenities – including its heritage spaces, spa, restaurant and bars – as well as its services, like signing privileges at restaurants and bars, preferred pricing, housekeeping and 24-hour in-residence dining.

The design of the hotel's interiors has been led by Pierre-Yves Rochon and, similar to the design of the residences, is aimed at creating a contemporary experience for guests while respecting and celebrating the building's signature Art Deco heritage.

"The Waldorf's beautiful architectural character from the American 1930s is the perfect mix of classic and modern, and the ideal setting for a timeless luxury hotel," said Rochon. "The Waldorf Astoria has always had a special place in my heart, and working with this team to respect the history of the space while bringing it to a new era has been a dream come true."

March 5, 2020
CLAD News

To ensure the building's heritage is adequately retained while it is modernised, expert preservationists were enlisted and years of work were carried out to understand its history.

"We started this project from a place of profound respect for the building's heritage, and detailed research into its history, including all of the changes made to it over the years," said Frank Mahan, associate director of SOM. "We are not only returning the building to its former glory, but also adapting it and making it relevant for future generations."



The Starlight Terrace will provide views of the surrounding area



The building is being updated with a contemporary design that honours its history

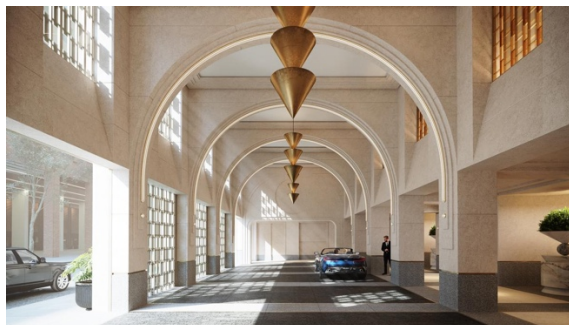

A porte cochère with double-height vaulted ceilings will offer residents a private entry

March 5, 2020
CLAD News



In addition to a 375-key hotel, the newly revamped destination will offer 375 condominium residences



The Waldorf Astoria was originally designed by Schultze and Weaver



It was the largest and tallest hotel in the world when it opened on Park Avenue in 1931

March 5, 2020
CLAD News



In addition to a 375-key hotel, the newly revamped building will offer 375 condominium residences



The residences will be known as The Towers of the Waldorf Astoria



Homes will range from studios up to four-bedroom apartments and penthouses

<https://www.cladglobal.com/news.cfm?codeid=344862>